



STRATEGIC LOCATION

Jackson's Pointe is a newly developed park located in Butler County off the Evans City/SR 528 exit of I-79. This new and desirable park is perfect for office, retail, distribution, flex, technology, and light manufacturing with direct access to Rt. 19/Perry Highway. Also located minutes from historical downtown Zelienople.

- ✓ Flexible lease terms
- ✓ Zoned commercial corridor (cc)
- ✓ Pad ready sites
- ✓ Serviced by three (3) signalized intersections



[For More Information or to Schedule a Tour](#)

One Waterfront Place, 1251 Waterfront Place, Suite 201, Pittsburgh, PA 15222
brgoetz@buncher.com • gbroujos@buncher.com • jddepaulo@buncher.com
412.422.9900

Disclaimer:

No express representation or warranty is made nor is any to be implied as to the accuracy of the information furnished regarding the property thereof, and it is submitted subject to errors, omissions, or other conditions, prior lease, or withdrawal without notice.

PROPERTY HIGHLIGHTS

- ✓ Flexible Lease Terms
- ✓ Serviced by three (3) signalized intersections
- ✓ Zoned Commercial Corridor (cc)
- ✓ High visibility from all directions
- ✓ Average Daily Traffic (ADT) 23,000-32,000 along Rte. 19
- ✓ Pad ready sites
- ✓ All utilities to the site

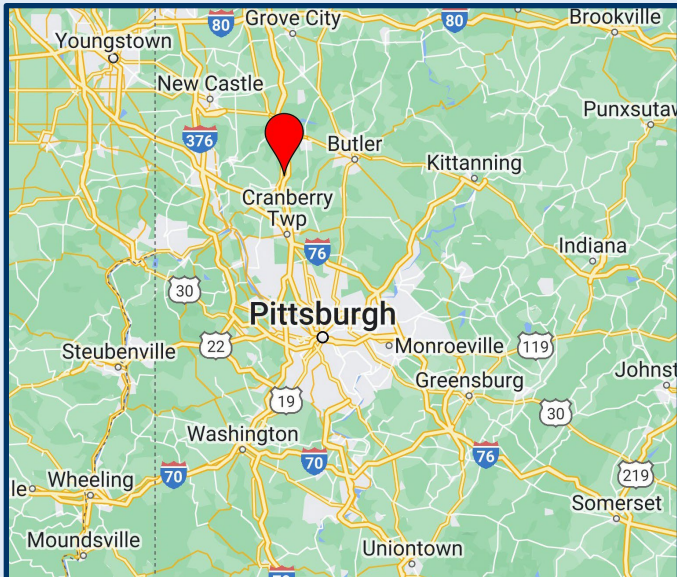
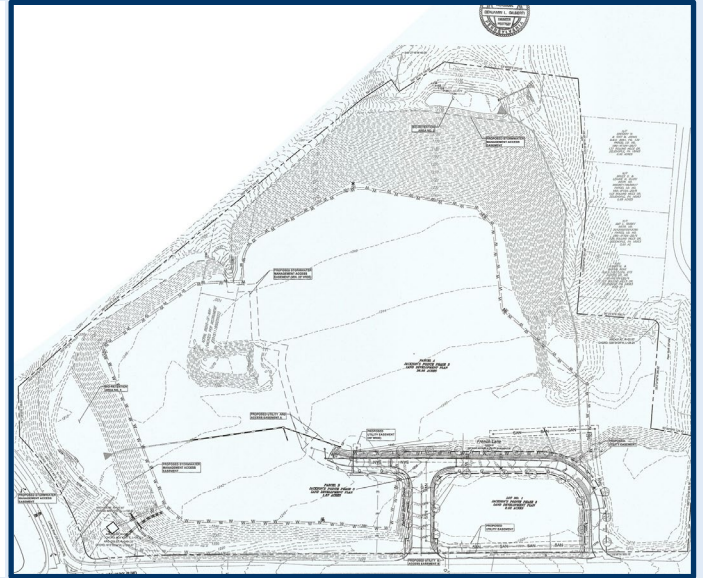

LOCATION HIGHLIGHTS

- ✓ Directly off Evans City exit of I-79
- ✓ 10 minutes to PA Turnpike (PA-76)
- ✓ 30 minutes to Downtown Pittsburgh
- ✓ 5 minutes to Cranberry Township
- ✓ Located minutes from historical Downtown Zelienople

BUNCHER
COMPANY

Developing with a Purpose

NAIOP



For More Information or to Schedule a Tour

One Waterfront Place, 1251 Waterfront Place, Suite 201, Pittsburgh, PA 15222

brgoetz@buncher.com • gbroujos@buncher.com • jddepaulo@buncher.com

412.422.9900