

ONE WATERFRONT PLACE

1251 WATERFRONT PLACE

FOR LEASE

Prime location in
Pittsburgh's famed

STRIP DISTRICT

BUNCHER[®]
COMPANY



PROPERTY FEATURES

One Waterfront Place is strategically located adjacent to the Central Business District in Pittsburgh's Historic Strip District. Suites ranging from 5,738 - 16,088 SF.

THIRD FLOOR

16,088 SF suite available

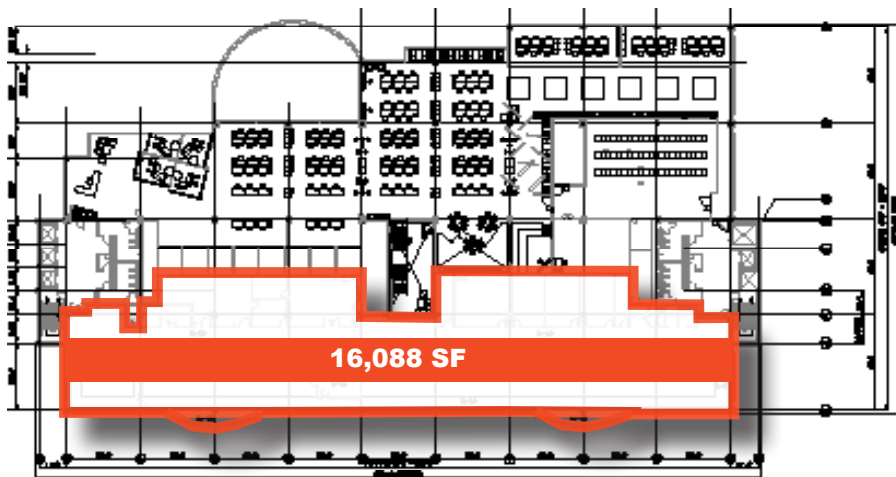

FIFTH FLOOR

5,738 SF suite available

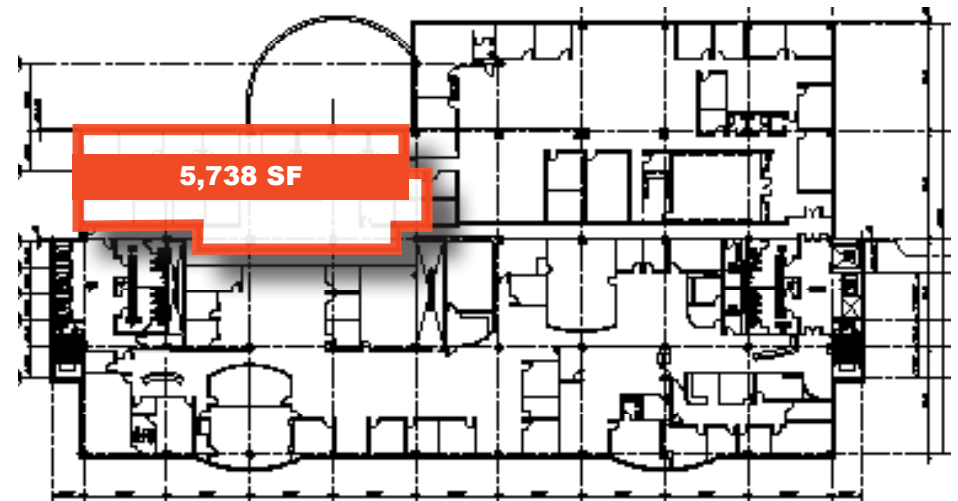

- Class A office finishes tailored to tenant's requirements
- 10 minute walk to Central Business District
- 10 minute walk to Strip District, live-work-play amenities
- High ceilings - large windows - tons of natural light

- On-site cafeteria with outside patio area along riverfront; grab n' go food service
- Top floor with riverfront views (5,738 SF suite)
- Ample parking surrounding One Waterfront Place, controlled by Landlord



Less than 10 minute walk
to
Central Business District



Less than 10 minute walk
to the center of the
Strip District



Easy access to I-376, I-279,
I-579, Route 65 and
Route 28

ONE WATERFRONT PLACE



Penn Avenue
Smallman Street



CONTACT US

Gregg Broujos
gbroujos@buncher.com

Dino DePaulo
jddepaulo@buncher.com

1251 Waterfront Place, Suite 201
Pittsburgh, PA 15222
412.422.9900

Disclaimer:

No express representation or warranty is made nor is any to be implied as to the accuracy of the information furnished regarding the property thereof, and it is submitted subject to errors, omissions, or other conditions, prior lease, or withdrawal without notice.