

2010 Jacksons Pointe Court

Building #2000, Zelienople PA 16063
Warehouse / Office Space | For Lease

BUNCHER.
COMPANY



Jackson's Pointe Commerce Park

41,644 SF Available

- Exterior pre-cast structural concrete panels with interior rigid steel frame construction
- 20 gauge galvanized steel decking insulated, single membrane rubber roof system
- 30' clearance under beam
- 48' x 48' column spacing
- T-5 high output lighting, 6 lamp fixtures
- Two (2) 8' x 10' vertical lift manual overhead doors at dock height with dock bumpers

For More Information or to Schedule a Tour

One Waterfront Place

1251 Waterfront Place, Suite 201
Pittsburgh, PA 15222
412.422.9900

Gregg Broujos | gbroujos@buncher.com
Dino DePaulo | jddepaulo@buncher.com





41,644 Square Feet Available

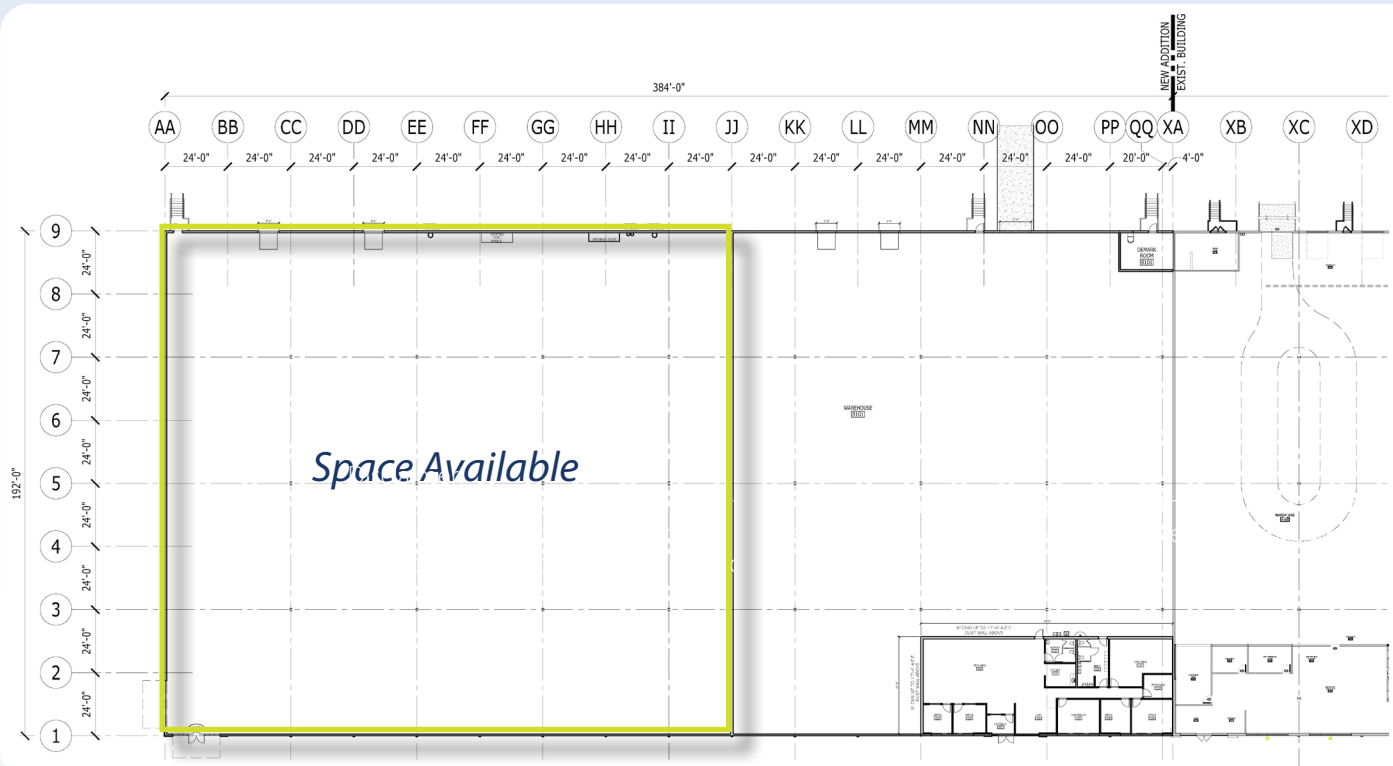

20 Minute Drive-Time *Demographics*



Households:
46,652



Population:
117,956



Average Household Income:
\$145,495

Disclaimer:

No express representation or warranty is made nor is any to be implied as to the accuracy of the information furnished regarding the property thereof, and it is submitted subject to errors, omissions, or other conditions, prior lease, or withdrawal without notice.

BUNCHER
COMPANY